

Buyer _____
 Approved: _____
 Date: _____

WINDOW SCHEDULE						
SYMBOL	SIZE	MATERIAL	TYPE	HEADER	COMMENTS	QUANTITY
(01)	PR-3o5o	VINYL	SINGLE-HUNG	(2)2'X10"	INSULATING	1
(02)	3o1o	VINYL	SLIDER	(2)2'X8"	INSULATING-OBSCURED	3
(03)	3o5o	VINYL	SINGLE-HUNG	(2)2'X8"	INSULATING	3
(04)	1o6o	VINYL	SIDELIGHT		INSULATING	2
(05)	1Oo5o	VINYL	DBL-SLIDER	(2)9-1/2"LVL5	INSULATING	1

DOOR SCHEDULE					
SYMBOL	WIDTH	HEIGHT	HEADER	NOTES	QUANTITY
(1)	3'-0"	6'-8"		INSULATED DOOR	1
(2)	3'-0"	6'-8"	(2)2'X8"	20 MIN. INSULATED DOOR	1
(3)	3'-0"	6'-8"		INTERIOR DOOR	3
(4)	3'-0"	6'-8"		POCKET DOOR	1
(5)	2'-6"	6'-8"		SOLID BARN DOOR	1
(6)	2'-4"	6'-8"			3
(7)	PR-3'-0"	6'-8"		BI-PASS DOOR	1
(8)	PR-2'-6"	6'-8"	(2)2'X10"	SLIDING GLASS PATIO / INSULATED	1
(9)	2'-6"	6'-8"		POCKET DOOR	1
(10)	PR-2'-0"	6'-8"		BI-PASS DOOR	2
(11)	9'-0"	8'-0"	(2)9-1/2"LVL5	OVERHEAD DOOR	1
(12)	16'-0"	8'-0"	(3)11-7/8"LVL5	OVERHEAD DOOR	1
(13)	2'-6"	6'-8"		INTERIOR DOOR	2

GENERAL NOTES:

EXTERIOR DOORS: 1-3/4" INSULATED PRE-HUNG VINYL CLAD or WD (PRE-BORED FOR LOCKS & DEADBOLT)
 INTERIOR DOORS: 1-3/8" PRE-HUNG HOLLOW CORE WOOD. LEVER-TYPE LOCKSETS, DOORS & HARDWARE AS APPROVED BY OWNER.
 OVERHEAD DOOR: 1-3/4" INSUL. ROLL-TYPE DOORS w/TRACK, GUIDES, AUTO OPEN & LOCKS.
 EXTERIOR WINDOWS: INSULATING VINYL, LOW "E" GLAZING, U-VALUE CERTIFIED.
 CLOSETS: 1-1/2" PAINTED SHELF, 1- METAL POLE, SHELF @ 68" A.F.F. CONFIGURATION BY CONTRACTOR.

BATH: LAVATORY SINK BASIN, T.P. HOLDER, ROBE HOOK ON DOOR (PRIMARY), TOWEL BARS (1-24", 1-36").

KITCHEN & BATH CABINET & CTR. TOP DESIGN BY OTHERS.
 EXTERIOR FINISH as NOTED ON PLAN, DRYWALL INTERIOR FINISH MOISTURE-RESISTANT DRYWALL "GREENBOARD" IN BATHS & SINK.

PROVIDE GUTTER & DOWNSPOUT SYSTEM TO PROVIDE POSITIVE DRAINAGE AWAY FROM STRUCTURE. DO NOT SCALE DRAWINGS.

DIMENSIONS TAKE PRECEDENCE OVER SCALE; LARGER SCALE OVER SMALLER SCALE, & DETAILS OVER NOTES. GEN'L CONTRACTOR & SUB-CONTRACTORS SHALL VERIFY DRAWINGS & SITE CONDITIONS BEFORE COMMENCEMENT OF THE WORK.

ANY DISCREPANCY IN THE DRAWINGS OR DOCUMENTS SHALL BE BROUGHT TO THE ATTENTION OF THE ARCHITECT/ENGINEER PRIOR TO COMMENCEMENT OF THE WORK.

ALL WORK SHALL COMPLY WITH THE MOST CURRENT ADOPTED I.R.C., STATE ENERGY CODE, & LOCAL BLDG. DEPT. REQMTs.
 PRE-MANUFACTURED FLR. & ROOF TRUSSES AS APPROVED BY THE ARCHITECT/ENGINEER.
 ATTIC SPACE VENTILATION PER I.R.C. R806.

ELECTRICAL NOTES:

ELECTRICAL CONTRACTOR TO SUPPLY ALL LABOR & MATERIAL TO PERFORM THE WORK PER APPLICABLE GOVERNING CODE (NEC & LOCAL).
 THE WORK SHALL INCLUDE: FAN/LITES, SWITCHES, MOTORS, RECESSED LIGHTS, SMOKE & CO2 ALARMS, OUTLETS, PANELS, BREAKERS, POWER & LIGHTING.
 OWNER SELECTION OF FINISHES (COLOR & TYPE) BEFORE INSTALLATION.

MECHANICAL:

MECHANICAL CONTRACTOR TO SUPPLY ALL LABOR & MATERIAL TO PERFORM THE WORK PER APPLICABLE GOVERNING CODEs (UMC, UPC, & LOCAL).
 GOVERNING CODE (UMC, UPC, & LOCAL).
 THE WORK INCLUDES: 50 GALLON GAS-FIRED WTR. HTR, AIR-CONDITIONING, VENTING, MAKE-UP AIR FOR EXHAUST FANS, WATER CLOSETS, TUB & ENCLOSURE, SHOWER, SHOWER PAN OR ENCLOSURE & LAVs. FORCED-AIR HEAT SYSTEM & FURNACE STAINLESS STEEL DOUBLE SINK w/GARBAGE DISPOSAL, ICE-MAKING CONNECTION (FOR REFRIGERATOR), UNDER-COUNTER DISHWASHER.

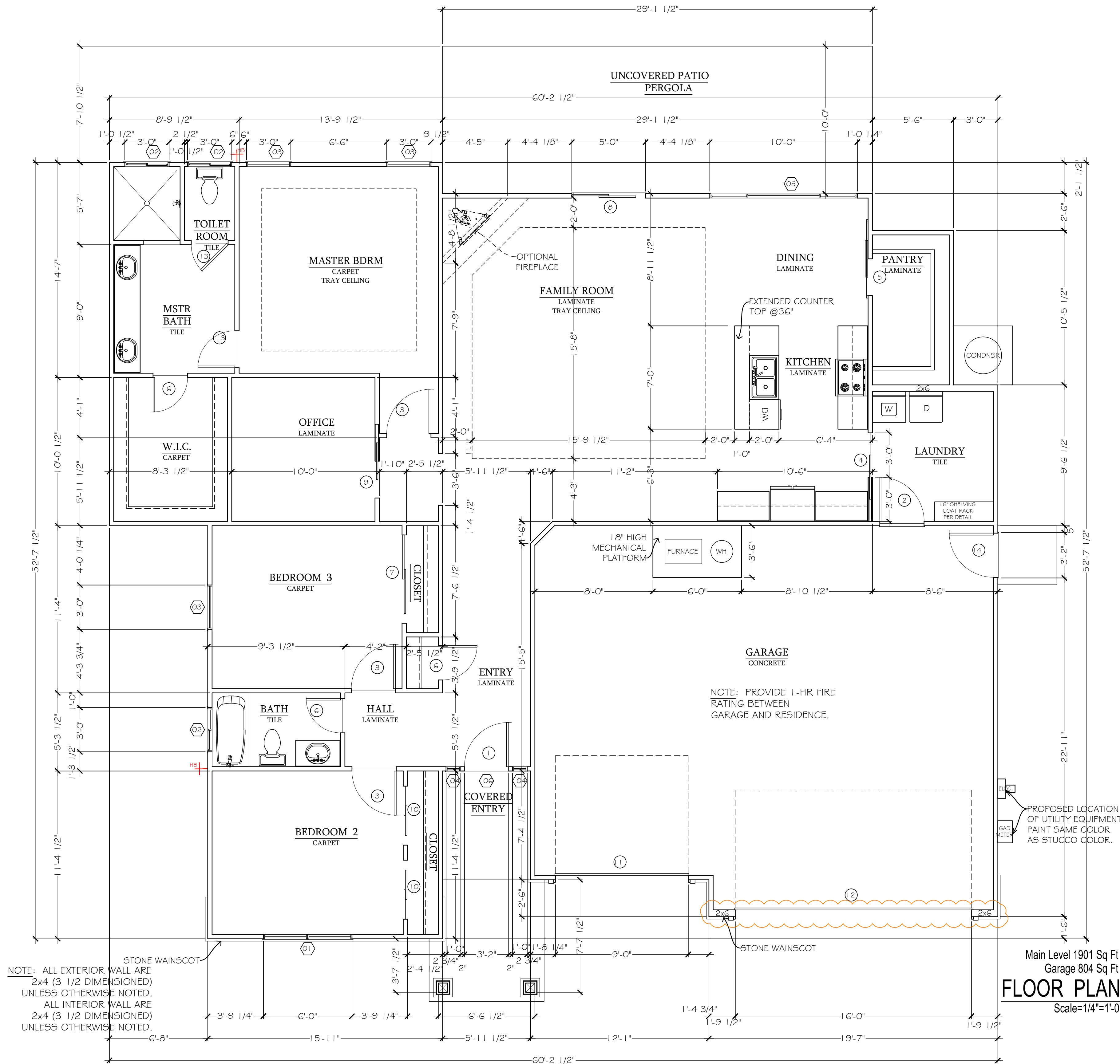

Main Level 1901 Sq Ft
 Garage 804 Sq Ft
FLOOR PLAN
 Scale=1/4"=1'-0"

NOTE: ALL EXTERIOR WALL ARE 2x4 (3 1/2 DIMENSIONED) UNLESS OTHERWISE NOTED.
 ALL INTERIOR WALL ARE 2x4 (3 1/2 DIMENSIONED) UNLESS OTHERWISE NOTED.

DISCLAIMER
 This plan is not 100% to scale as internal dimensions may vary, however total square footage figures or appliances shown other than those noted in your specifications are for effect only and not included.
 COPYRIGHT
 This drawing remains the property of Integrity Homes, LLC, and may not be used or reproduced in whole or without written permission.

INTEGRITY HOMES
 Phone: 970-255-6930 Fax: 970-255-1017
 1380 North Ave.
 Grand Junction, CO 81501

249 ESPERANZA CT.
 Casa Rubi-Spec.
 Grand Junction, CO

GOLD Inclusions

Revisions
 9-16-2020 Revised garage door header per structural engineer.

Phase CD Date 4-SEP-2020 Drawn by: EG

FLOOR PLAN

A1

CONSTRUCTION DOCUMENTS

NOTE: 1/4" x 1/4" Drawings are printed at Half Scale.